

5 KEY COMPONENTS

CULTURE

“Grove Town Dwellings embrace the various cultures brought to the community. Each space throughout the home can be unique to every family. .”

AFFORDABILITY

“The benefits of living in a multigenerational home are highlighted with the feeling of financial security along with the confidence of having a quality built, forever home.”

INCLUSIVE

“Inclusive design is utilized in various details, along with the ability to personalize each space.”

SUSTAINABLE

“With an overall community focus on sustainability and the value of being a neighbor, each home has it’s own private space creating the true sense of ownership.”

HOME

“These units are perfect for families who appreciate the benefits of living ‘together but separate’.”



KITCHEN PERSPECTIVE



Goal: Include sustainable and energy efficient products and materials.

- Zero VOC paint used throughout the spaces to provide a better indoor air quality.
- Kitchen is fully equipped with affordable appliances and materials.
- Cabinet pulls used for ease of use.
- Energy Star Rated appliances utilized for sustainability.
- Neutral color palette selected to appeal to all cultures.
- Custom element designed to provide flexible use throughout the kitchen and dining area.



Vinyl Tile

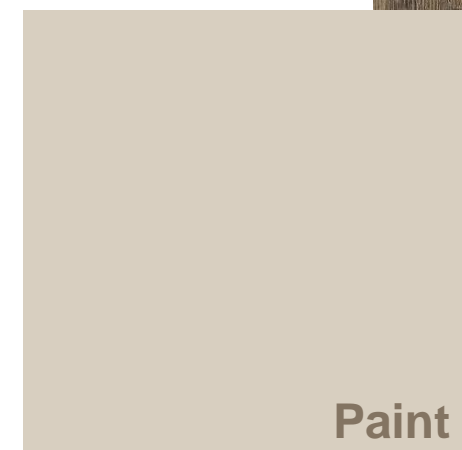

Paint

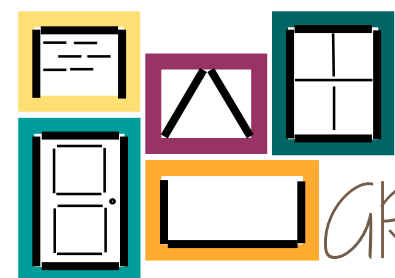

GROVE TOWN DWELLINGS

LIVING ROOM



Goal: Design a home that encourages family interaction, but spaces that also give privacy and separation.

- Ottoman poufs added to center of room for additional seating.
- Exterior door allows natural light to enter into the space.
- Exterior door allows natural light to enter into the space and provides access to backyard community.
- Bright colors added to accent the space through color theory research.
- Furniture selected to support sustainability and local economy.
- Open concept shown throughout living room into kitchen and dining area.

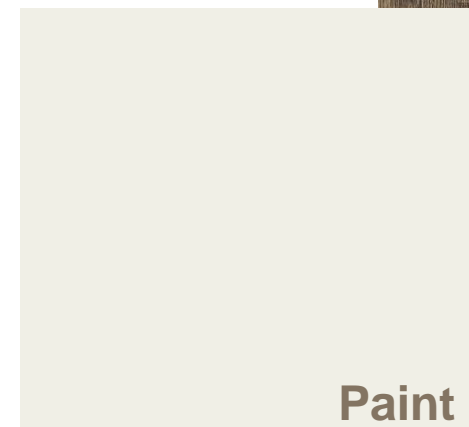

GROVE TOWN DWELLINGS

MAIN BEDROOM



Goal: Allow for the ability of any user to access the space through Universal/Inclusive Design.

- Main bedroom on first floor to allow for accessibility.
- Bright colors added to accent the space through color theory research.
- Double pane sliding egress windows to allow for sustainability, acoustics, and safety.



Carpet



Paint

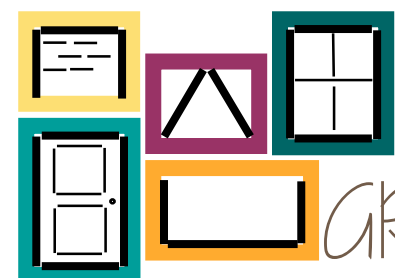

GROVE TOWN DWELLINGS

2ND FLOOR LOFT

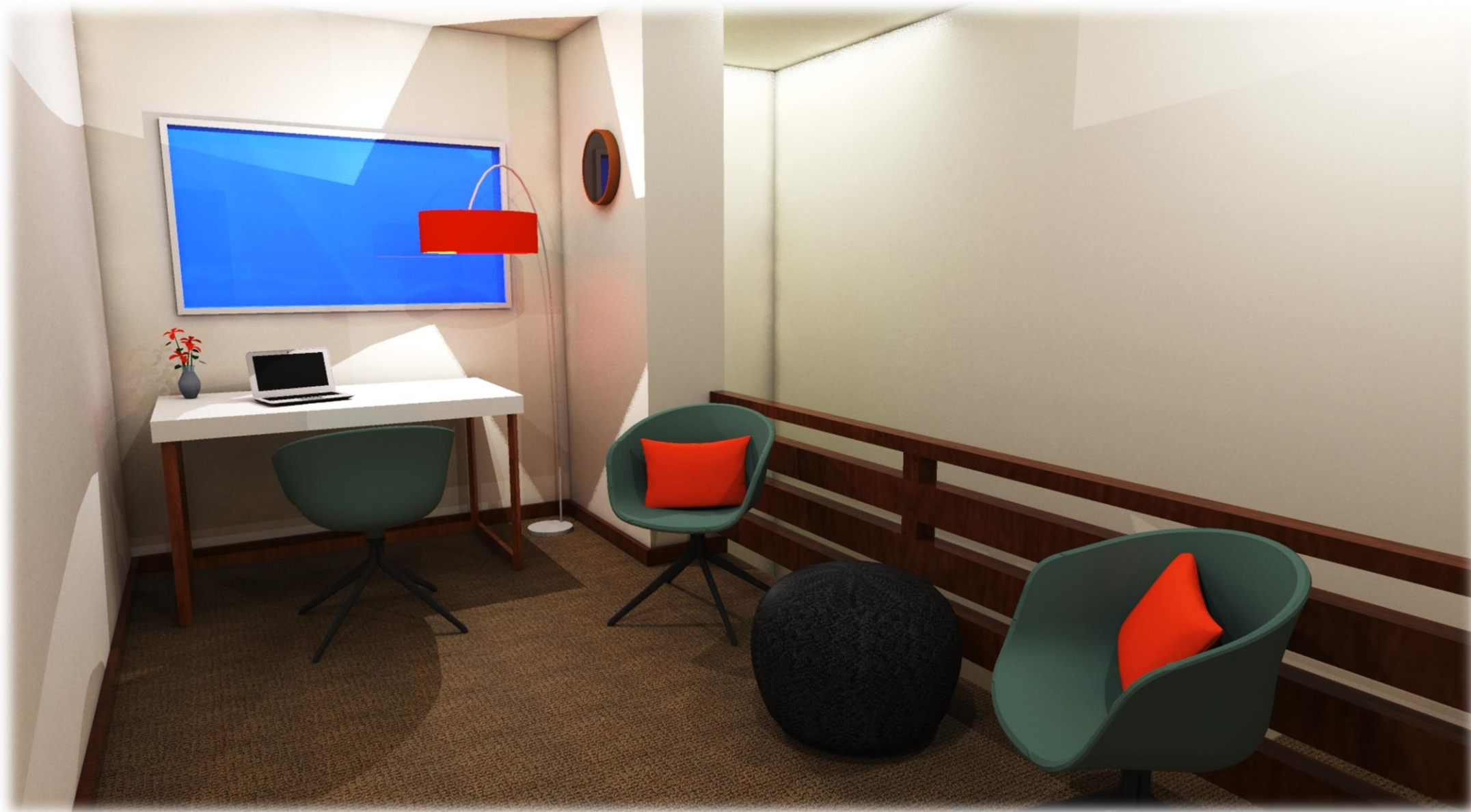

Goal: Design a home that encourages family interaction, but spaces that also give privacy and separation.

- Eco-friendly wood selected for hand rails to save in cost.
- Loft area created to give the homeowners a sense of togetherness but separate.
- Window placement provides natural light but also privacy to the space.

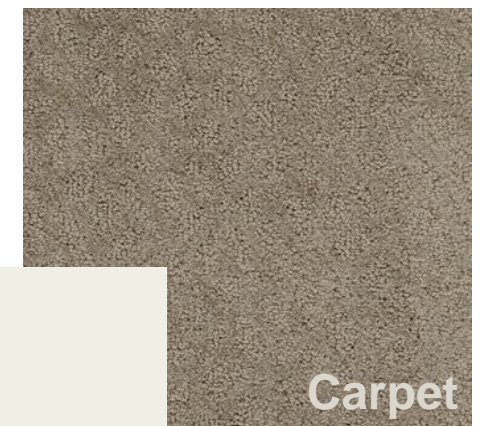

Carpet

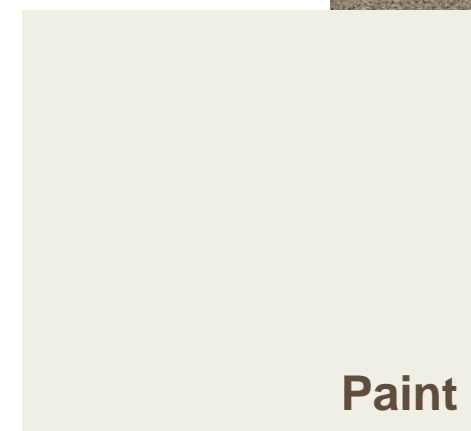

Paint

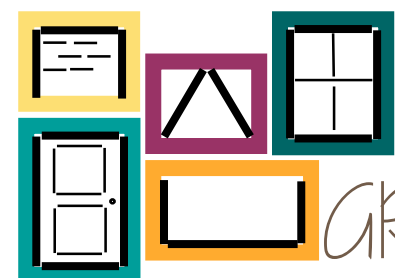

GROVE TOWN DWELLINGS

MASTER BEDROOM



Goal: Stage the home in a way that allows any user to visualize their own families within the space.

- Windows to allow natural light into the space.
- Queen size bed selected for ownership to the home.
- Master closet created to provide organization and accessibility.
- Upholstered provides safety, comfort, and extra storage.



GROVE TOWN DWELLINGS

FIRST FLOOR PLAN

Natural light used throughout the home to filter into each floor.

Cabinet pulls and door levers used through the home for ease of use.

Doors throughout the home are 3'-0" wide to allow for accessibility.

3'-0" clearance in main bedroom for accessibility.

Main floor bathroom is equipped with roll-in shower and slip resistant flooring for accessibility and safety.

Open floor plan to encourage a sense of togetherness but separate.

Main entry door is 42" to allow for accessibility..

Lighting used along stairs for safety.

Seating provided inside of entry for accessibility.

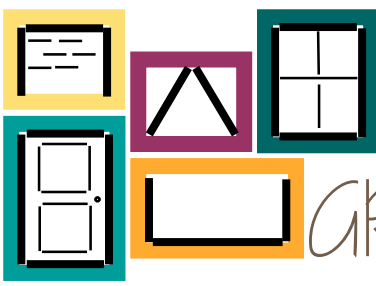

GROVE TOWN DWELLINGS

SECOND FLOOR PLAN

Closet organizers for accessibility,
safety, and space saving.

Large master bedroom creates
sense of ownership.

Natural light used throughout
the bedrooms to filter in
sunlight.

Double vanity provides extra
storage and allows for
multiple use.

Loft area provided for flexible
use and privacy.

Slip resistant flooring used
throughout the bathroom for
safety.

Doors throughout the home are
3'-0" wide to allow for
accessibility.

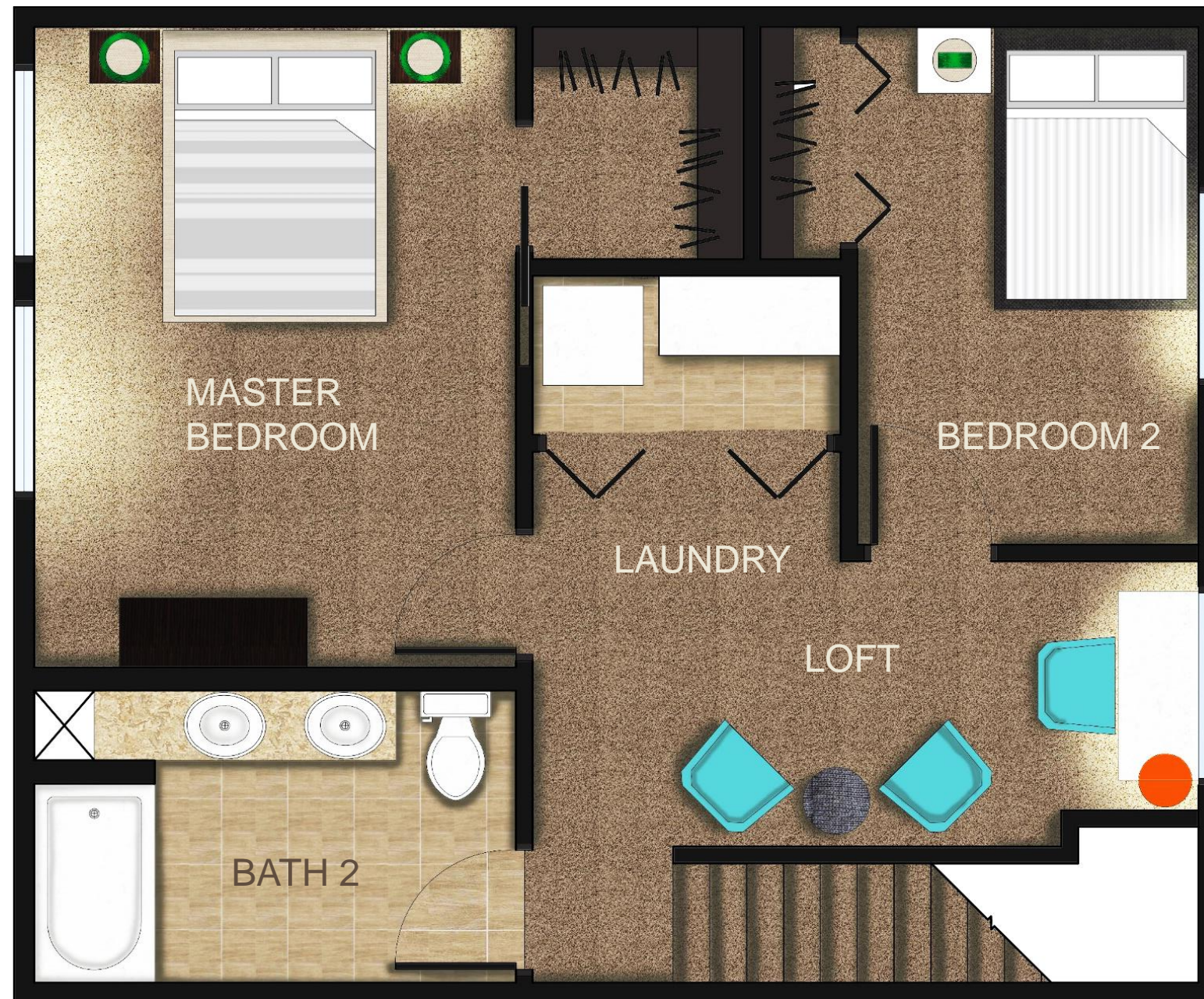

CUSTOM ELEMENT

A custom table was designed to create an accessible and flexible dining room. The concept for the table was to save space and allow for an open concept throughout the main floor of the home. The table can be used against the wall closed for storage, a prep area in the kitchen, open for a small table/ desk, or a large dining room table that seats up to 10 people. The overall design of the table is cohesive with the rest of the space in its neutral colors and clean aesthetics.



Elevation view of Custom Model

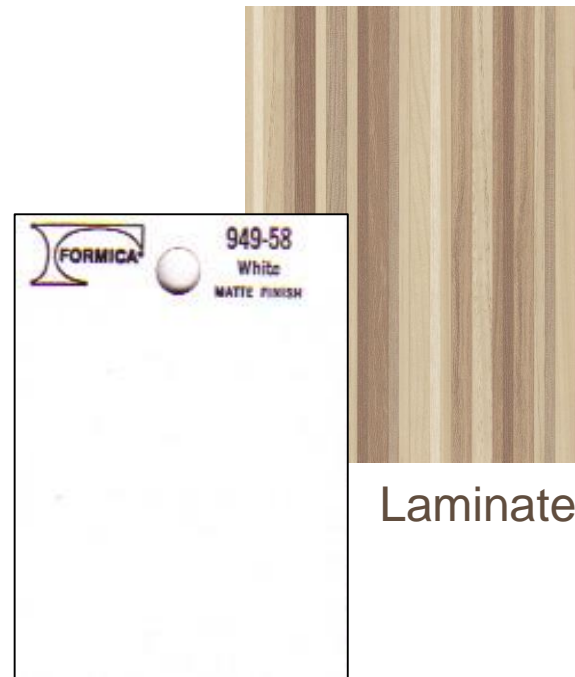

Laminate



3-D view of custom model open on one side